

INSTALLATION INSTRUCTIONS

RXV MY24+ Headlight Kits

Kit PN 10015493, 10036457, 10036454, 10036024,
10036456, 10015494, 10036931, 10035166

READ ALL INSTRUCTIONS BEFORE INSTALLING THIS KIT.



WARNING

Turn the key to the OFF position and remove it from the switch. Install wheel chocks in front and behind each wheel before installation procedure.

To prevent battery explosion that could result in severe personal injury or death, keep all smoking materials, open flames, or sparks away from the batteries.

Use insulated wrenches to decrease the risk of a dropped wrench from shorting out a battery, which could result in an explosion and severe personal injury or death.



When you service the vehicle, always wear eye protection. Be careful when working around batteries, or using solvents or compressed air.

KIT PART NUMBER

	10036458	10036455	10015456	10015449	10030401G01 10030401G02	10008164	10008165	698194	Page #'s
PKG									
10015493			X		X	X		X	11, 10, 8
10036457	X				X	X		X	11, 10, 8
10036454		X			X	X		X	11, 10, 8
10036024		X			X		X		11, 10
10036456	X				X		X		11, 10
10015494			X	X	X	X		X	11, 12, 10, 8
10036931			X	X	X		X		11, 12, 10
10035166			X		X		X		11, 10

QUANTITY								ITEM #	DESCRIPTION	PART #
1	1	1	1	1	1	1	1	1	TAILLIGHT TEMPLATE	10045979
--	1	1	--	--	--	--	--	--	LED LIGHT W/SWITCH UPGRADE KIT (INCLUDES ITEMS 2 - 9)	10036458
--	1	1	--	--	--	--	--	2	HEADLIGHT ASSEMBLY, LED, LEVEL 2, LH	10047123G21
--	1	1	--	--	--	--	--	3	HEADLIGHT ASSEMBLY, LED, LEVEL 2, RH	10047123G22
--	1	1	--	--	--	--	--	4	LIGHT CONTROL HARNESS, LEVEL 1&2	10011035
--	1	1	--	--	--	--	--	5	TURN SIGNAL CONTROLLER	10021930
--	1	1	--	--	--	--	--	6	TURN SIGNAL ROCKER SWITCH, CONTURA V	651897G10
--	1	1	--	--	--	--	--	7	2 POSITION ROCKER SWITCH, BLACK	651897G11
--	1	1	--	--	--	--	--	8	HEADLIGHT ROCKER SWITCH, CONTURA V	651897G07
--	4	4	--	--	--	--	--	9	T30 PLASTITE SCREW, M6X2.14X20	10033018
--	--	--	1	1	--	--	--	--	HALO LED LIGHT W/STALK UPGRADE KIT (INCLUDES ITEMS 10 - 19)	10036455
--	--	--	3	3	--	--	--	10	PLUG, PANEL, CARLING SWITCH	627035
--	--	--	1	1	--	--	--	11	HEADLIGHT ASSEMBLY, LED, LEVEL 3, LH	10047123G31
--	--	--	1	1	--	--	--	12	HEADLIGHT ASSEMBLY, LED, LEVEL 3, RH	10047123G32
--	--	--	1	1	--	--	--	13	TURN STALK HOUSING HARNESS	10024954
--	--	--	1	1	--	--	--	14	STEERING COLUMN COVER	10024955
--	--	--	1	1	--	--	--	15	TURN SIGNAL COVER SWITCH	10020050
--	--	--	2	2	--	--	--	16	TURN SIGNAL STRAP	10023448
--	--	--	4	4	--	--	--	17	HEX HEAD BOLT, M5X12	10025359
--	--	--	2	2	--	--	--	18	RATCHET RIVET	16816G2
--	--	--	4	4	--	--	--	19	T30 PLASTITE SCREW, M6X2.14X20	10033018
1	--	--	--	--	1	1	1	--	SIGNATURE HEADLIGHT UPGRADE KIT (INCLUDES ITEMS 20 - 28)	10015456
3	--	--	--	--	3	3	3	20	PLUG, PANEL, CARLING SWITCH	627035
1	--	--	--	--	1	1	1	21	HEADLIGHT ASSEMBLY, LED, LEVEL 4, LH	10047123G41
1	--	--	--	--	1	1	1	22	HEADLIGHT ASSEMBLY, LED, LEVEL 4, RH	10047123G42
1	--	--	--	--	1	1	1	23	RGB CONTROLLER	10006260
2	--	--	--	--	2	2	2	24	CABLE TIE	645340
1	--	--	--	--	1	1	1	25	RGB CONTROLLER REMOTE	10026480
1	--	--	--	--	1	1	1	26	PHOTOSENSITIVITY WARNING DECAL	10038194
2	--	--	--	--	2	2	2	27	HEADLIGHT ADAPTER HARNESS, RGB	10015236
3	--	--	--	--	3	3	3	28	NYLON CLAMP	17618G1
1	--	--	--	--	--	1	--	--	UNDERGLOW KIT (INCLUDES ITEMS 29 - 36)	10015449
1	--	--	--	--	--	1	--	29	RGB CONTROLLER	10006260
2	--	--	--	--	--	2	--	30	SECURABLE ZIP-TIE	645340
1	--	--	--	--	--	1	--	31	REMOTE CONTROL	10026480
2	--	--	--	--	--	2	--	32	28" LED SIDE TUBE	--
4	--	--	--	--	--	4	--	33	9" LED FRONT/REAR TUBE	--
14	--	--	--	--	--	14	--	34	INSULATED P-CLAMP	--
14	--	--	--	--	--	14	--	35	SELF-TAPPING SCREW	--
14	--	--	--	--	--	14	--	36	ZIP-TIE	--
1	1	1	1	1	1	1	1	37	PREMIUM LED TAILLIGHT ASSEMBLY, LH	10030401G01
1	1	1	1	1	1	1	1	38	PREMIUM LED TAILLIGHT ASSEMBLY, RH	10030401G02
1	1	1	1	1	1	1	1	39	HORN ASSEMBLY	604196
1	1	1	1	1	1	1	1	40	LOCK NUT, M6 - 1	601476
1	1	1	1	1	1	1	1	41	TORX BOLT, M6 - 1x20	601326
1	1	1	1	1	1	1	1	42	FRONT GRILL ASSEMBLY, SHORT	10046050
1	1	1	1	1	1	1	1	43	EZGO PLATINUM NAMEPLATE	10011930
8	8	8	8	8	8	8	8	44	PLASTITE SCREW, T20, #10 - 16 X.375	10030163
--	1	--	1	--	--	1	1	45	ACCESSORY HARNESS, LED, ELECTRIC VEHICLE, HANGING PEDALS	10008164

1	--	1	--	1	1	--	--	46	ACCESSORY HARNESS W/TIMER, ISG EFI, HANGING PEDALS	10008165
--	1	--	1	--	--	1	1	47	RXV, DC-DC CONVERTER W/BACKET ASSEMBLY	698914
--	2	--	2	--	--	2	2	48	FLAT WASHER, TYPE A	00559G8
--	2	--	2	--	--	2	2	49	HEX NUT, 5/16 - 18	00702G2
--	1	--	1	--	--	1	1	50	TORX SCREW, REMFORM, M8 X 3.50 X 30	649804
--	2	--	2	--	--	2	2	51	SELT TAPPING SCREW	608290
--	1	--	1	--	--	1	1	52	RATCHET RIVET	16816G5
1	--	1	--	1	1	--	--	53	RIVET, 3/16 DIAMETER	71055G01
3	--	3	--	3	3	--	--	54	NYLON CLAMP	17618G1
1	--	1	--	1	1			55	BRAKE PEDAL SWITCH	653242
2	--	2	--	2	2			56	SOCKET HEAD CAP SCREW, M5 X 0.8	620030
10036931	10036457	10036456	10036454	10036024	10035166	10015494	10015493			

VEHICLE PREPARATION

1. Compare the kit contents list to the parts packaged in the kit. Ensure all parts are included before beginning installation.
2. Park vehicle on a flat surface.
3. Turn the key to the OFF position and remove the key from the switch.
4. Chock wheels to keep vehicle from rolling.
5. Use an insulated wrench to disconnect the battery cables. Disconnect the negative (-) cable first, then disconnect the positive (+) cable.

A. Remove Dash Panel and Cowl

1. Remove windshield (if equipped):
 - a. Remove the four lock nuts (A) and four bolts (B) securing the lower portion of the windshield (C) to the vehicle.
 - b. Fold down the upper portion of the windshield.
 - c. Pull the rubber clips (D) away from the front strut.
 - d. Remove windshield from vehicle.

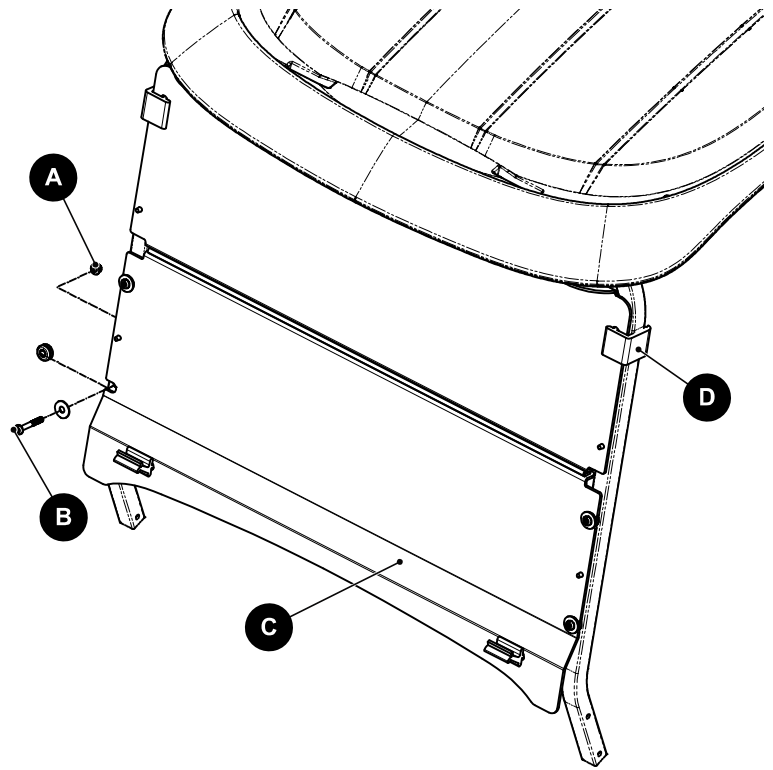

2. Remove the upper dash panel:
 - e. Slide the strut grommets (F) up the strut.
 - f. Remove strut covers (E) from dash.
 - g. Remove the two T30 plastite screws (G) securing the upper dash panel to the vehicle.
 - h. Remove upper dash panel (H).

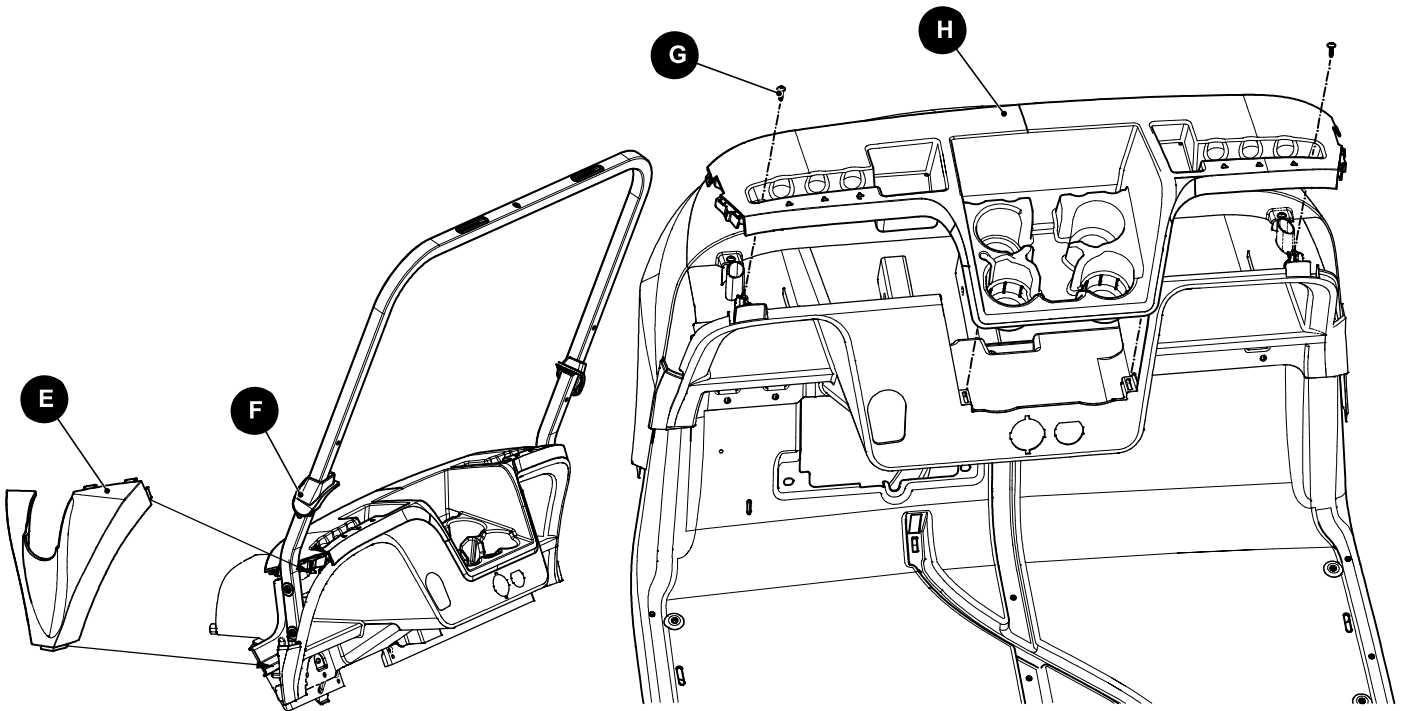

3. Remove the cowl by removing two T30 plastite screws (I) and pulling mounting tabs located at front bottom edge of cowl from the upper portion of the front fascia.

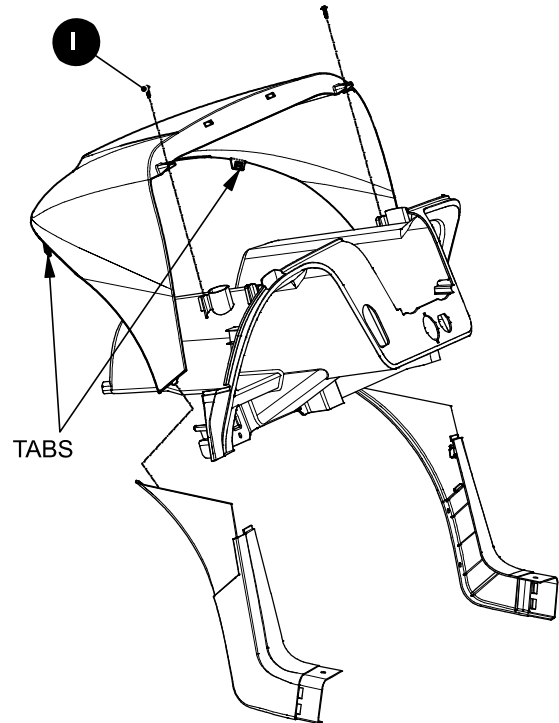

4. Remove fascia by removing two T45 Torx screws (J) and unhooking bottom edge from vehicle frame.

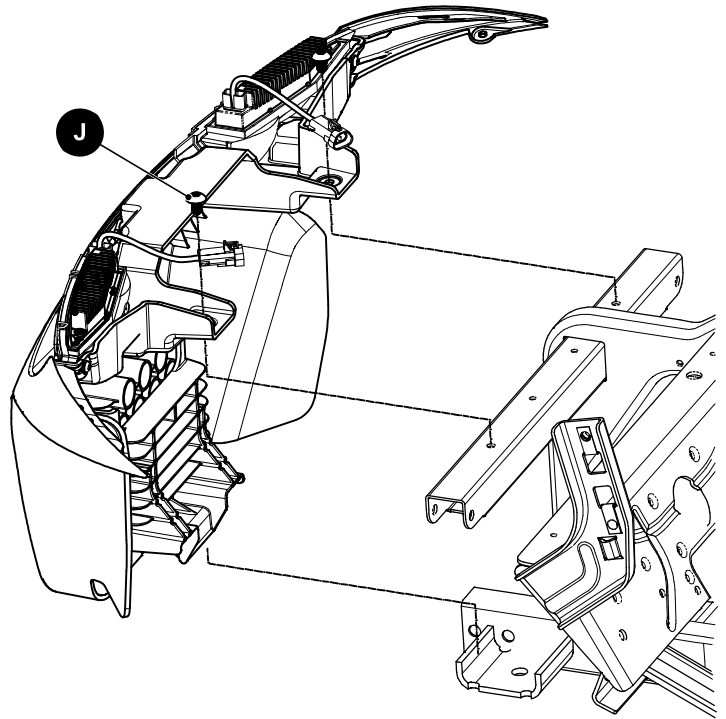

5. Install hanging pedal brake switch (gas vehicles only).
 - a. Remove two push rivets (N) from the inboard side and two bolts (Q) on the outboard side of splash pan on the backside of the brake pedal assembly. Remove splash pan (P).

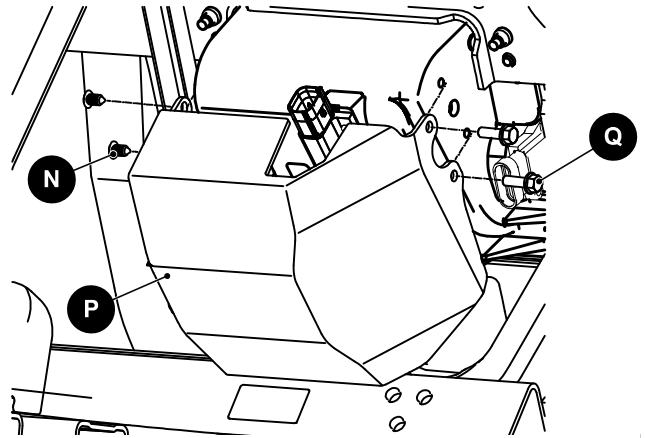

- b. Remove four M8 pan head screws (S) securing pedal assembly (R) to floorboard.
 - c. Remove pedal assembly (R) from floorboard.
 - d. Install brake pedal switch (55) using two screws (56).
 - e. Tighten hardware to the torque value shown below.

Item	Torque Specification
(56)	14 - 18 in. lbs (1.6 - 2 Nm)

6. Remove Torx screws that secure the rear body.

NOTICE: This step is necessary to allow routing of harness components. The rear body does not need to be removed.

- a. Front edge and seat support to floorboard (2 Torx screws)
 - b. Back edge of the seat opening (2 Torx screws)
 - c. Lower edge of the rear body to floorboard (4 Torx screws, 2 per side)

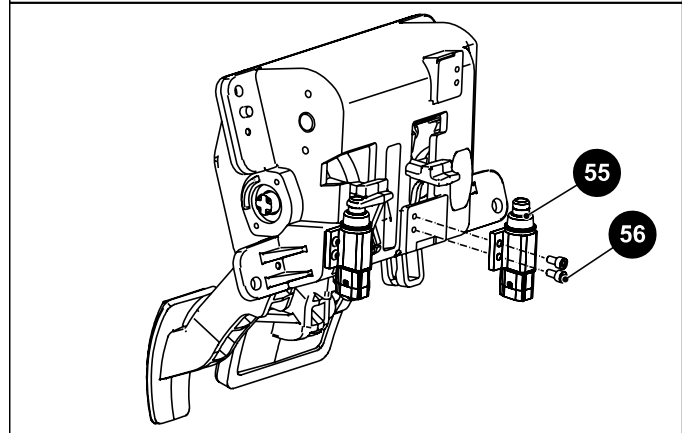
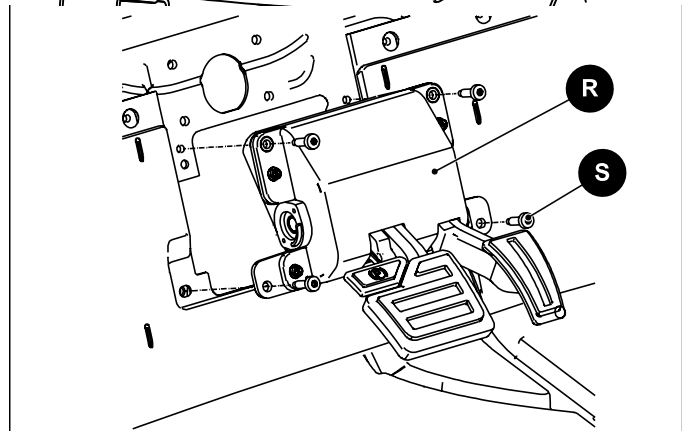

7. Remove the floor mat.
 - a. Remove the three plastite screws (K) securing the sill plate (L) to the vehicle. Remove sill plate.
 - b. Remove the four ratchet rivets (M) attaching the floor mat to the vehicle floor.

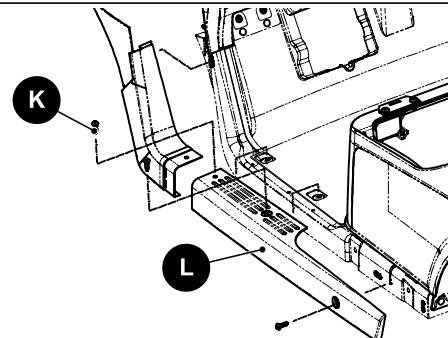

- c. Pull the edge of the floor mat from under the edge of the instrument panel and remove floor mat.

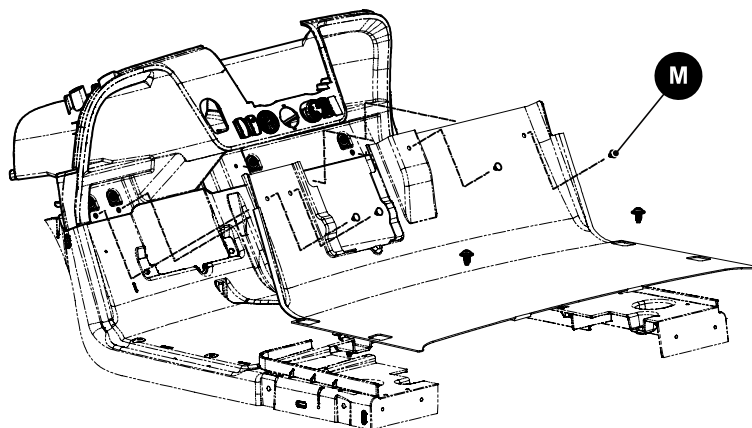

B. Wiring Connections

1

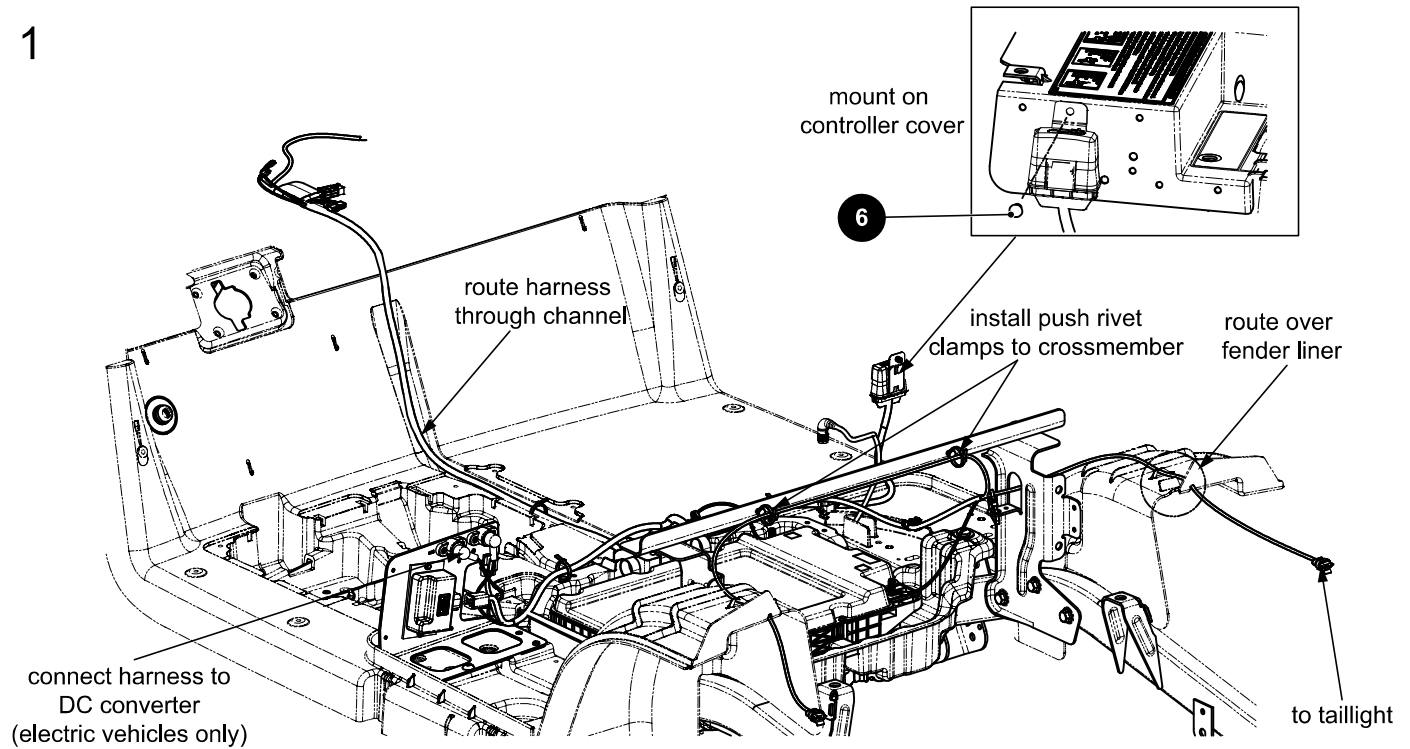

2

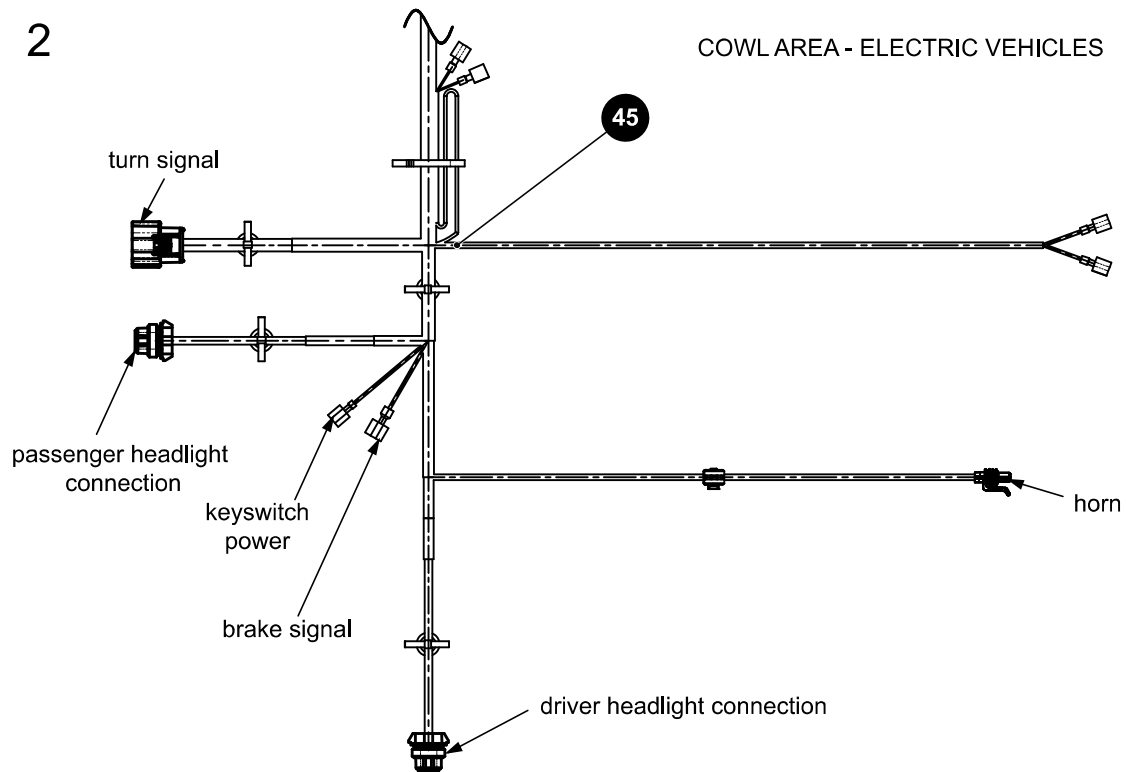

2

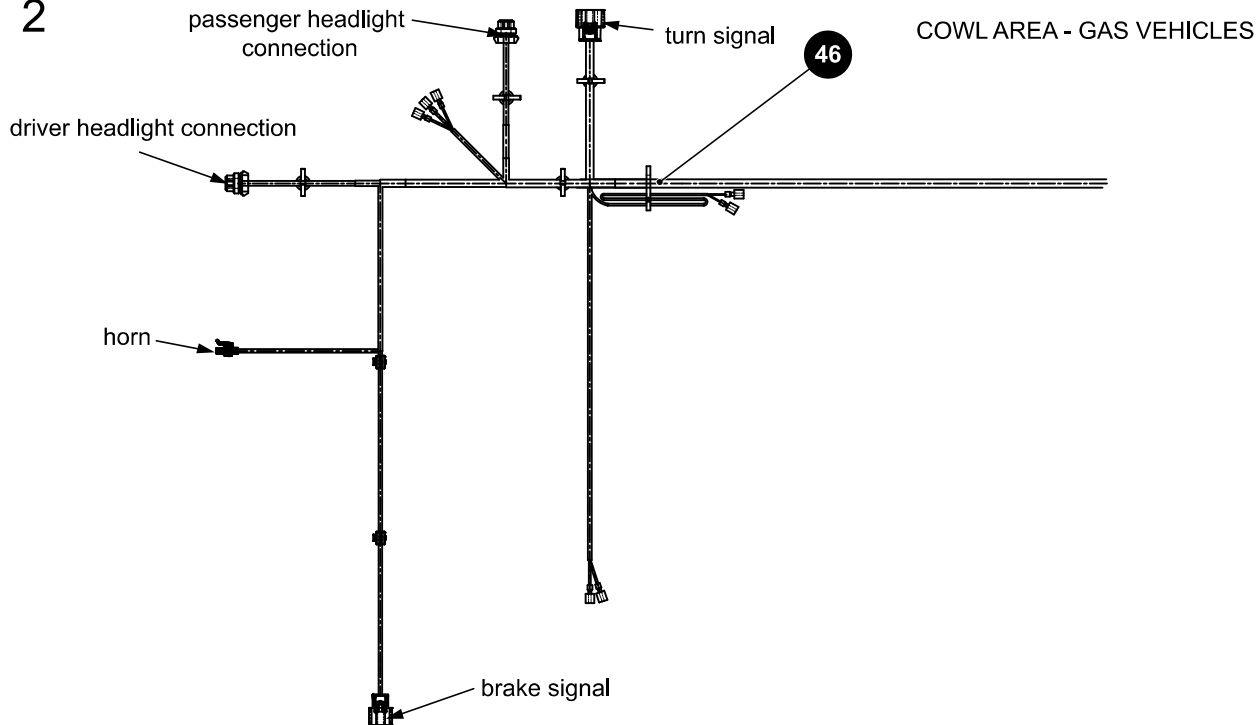

3

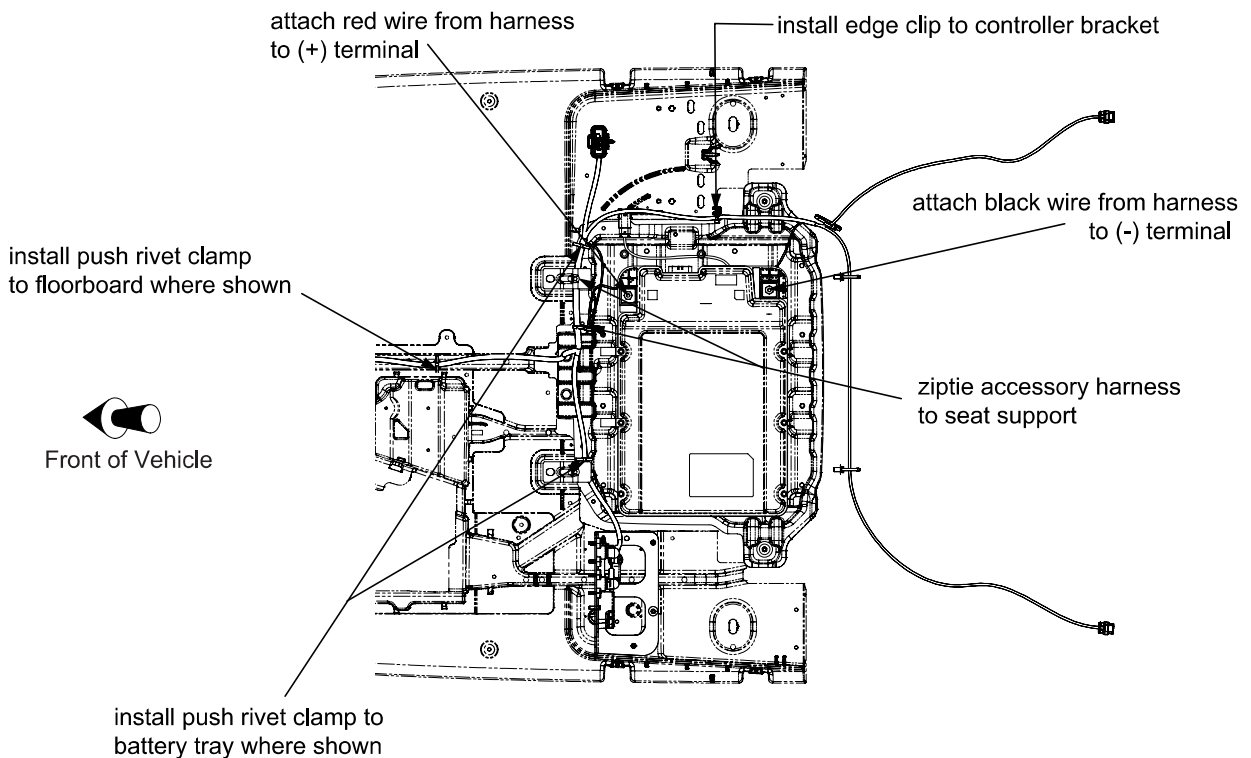

1. Route wiring harness (45/46) through channel as shown in images 1 - 3.
2. At the front of the vehicle (image 2, ELECTRIC and GAS vehicles):
 - a. Refer to appropriate headlight and turn signal kit for connections.
3. At the battery area and rear of the vehicle (images 1 & 3):
 - a. Route wiring harness to mounting points near of vehicle (see step C).
 - b. Attach wiring harness push rivet clamps to mounting points located on seat support, battery tray and floorboard where indicated in image 3.
 - c. Attach red wire from harness to the positive (+) terminal.
 - d. Attach black wire from harness to the negative (-) terminal.

4. At the DC converter (50) (electric vehicles):
 - a. Attach black wire to the negative (-) terminal with washer and nut. Cover connection with boot.
 - b. Attach red wire to the positive (+) terminal with washer and nut. Cover connection with boot.
 - c. Plug accessory harness into converter as indicated.
5. For gas vehicles:
 - a. Connect black wire to the negative (-) battery terminal.
 - b. Connect red wire to the positive (+) battery terminal.
 - c. Plug accessory harness (46) connection into pedal switch (55).
 - d. Reinstall brake pedal assembly and splash cover. Tighten hardware to the torque value shown below:

Item	Torque Specification
Torx screw (S)	14.7 - 15.8 ft. lbs (20 - 21.5 Nm)
bolt (Q)	4.6 - 5 ft. lbs (6.25 - 7 Nm)

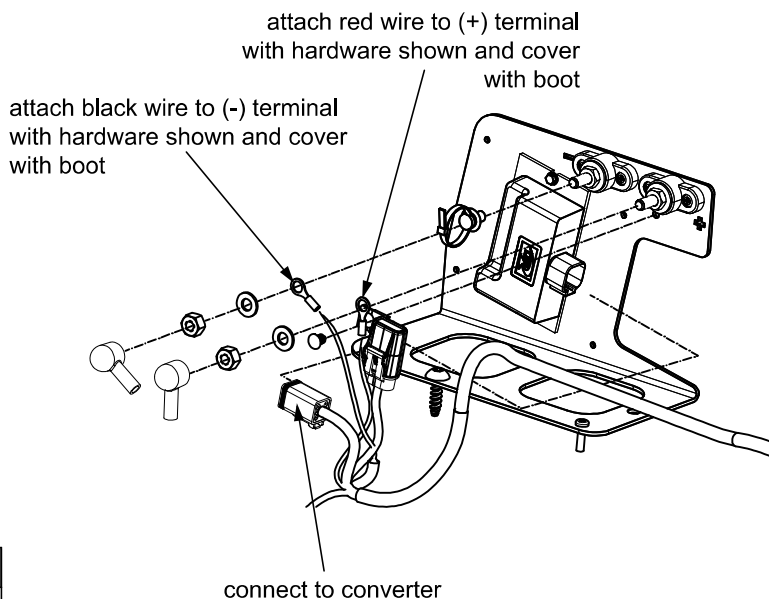

C. Taillight Installation

1. To prevent damage to painted surfaces, cover taillight area with masking tape.
2. Align template (1) with body lines as shown below:
3. Using a felt tipped pen, mark outline of template (1) onto vehicle.
4. Drill pilot holes as necessary before cutting.
5. Use a rotary cutting tool, jigsaw or other suitable cutting device to cut opening in cowl. Remove tape.

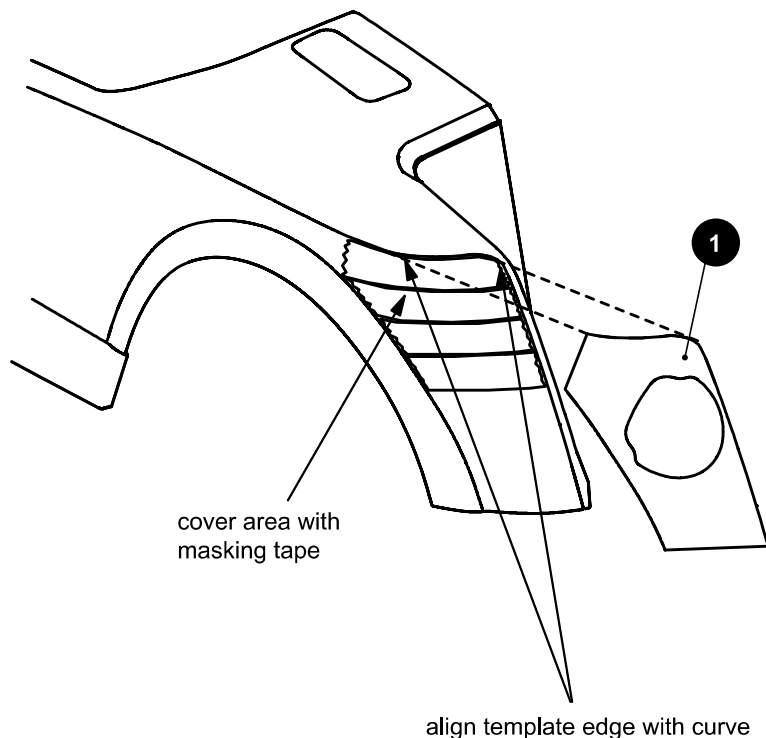

6. Secure wiring harness as shown (area located above rear wheel arches).

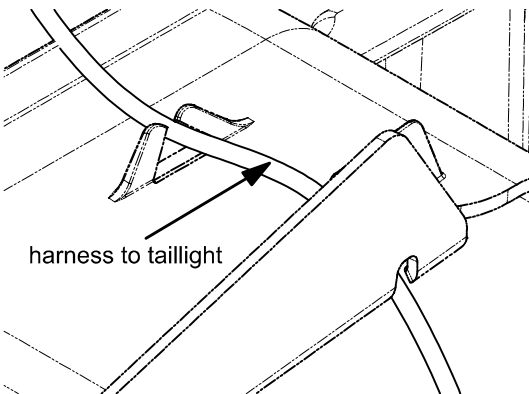

7. Plug in taillight as shown.

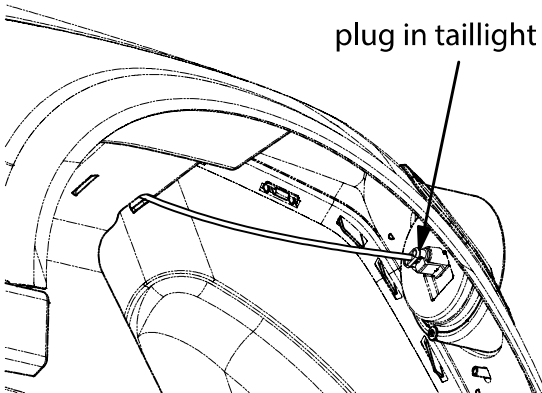

- 8. Insert and align taillight unit (37, 38) through opening cut into vehicle.
- 9. Mark and drill pilot holes for the four mounting points.
- 10. Secure taillight with four plastite screws (44).
- 11. Tighten hardware to the torque value shown below.

Item	Torque Specification
(44)	7.2 - 10.8 in. lbs (.8 - 1.2 Nm)

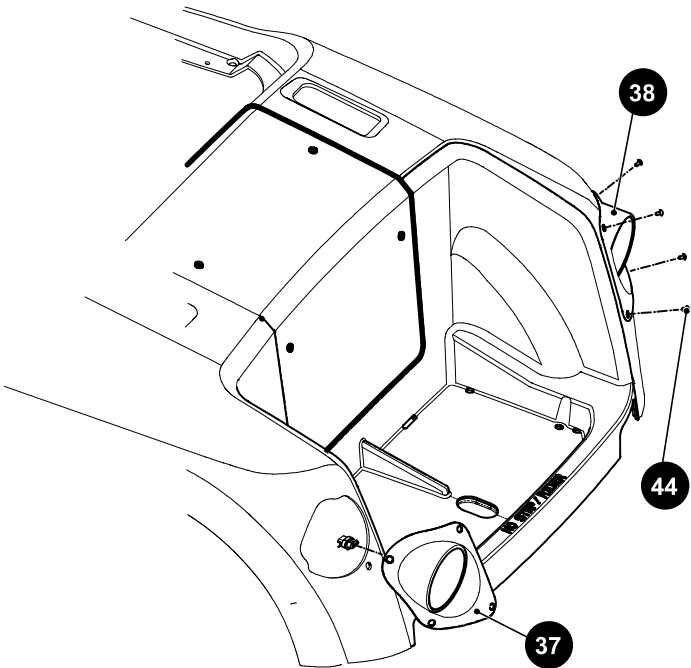

D. Headlight and Turn Signal Installation

1. Refer to appropriate kit instruction:
 - a. 10036458 - LED LIGHT W/SWITCH UPGRADE KIT
 - b. 10036455 - HALO LED LIGHT W/STALK UPGRADE KIT
 - c. 10015456 - SIGNATURE HEADLIGHT UPGRADE KIT

E. Underglow Kit Installation (PKG 10015494 and 1006931)

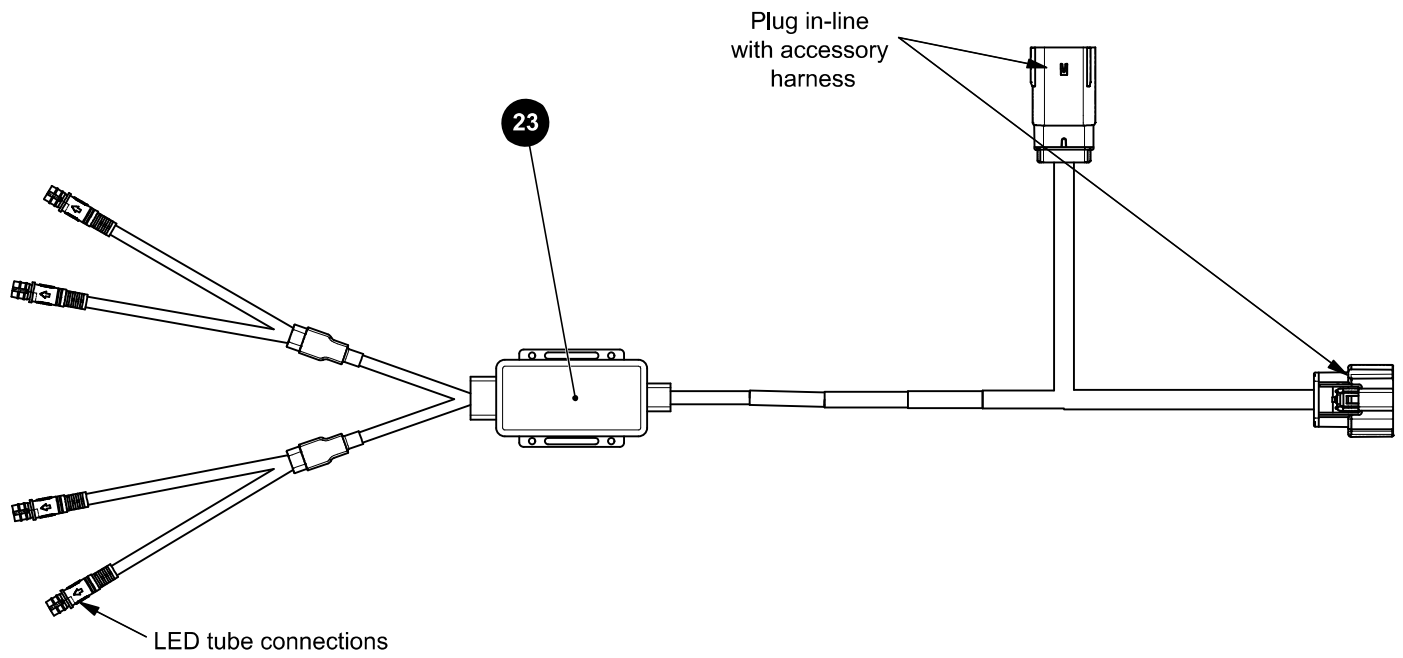

2. Reassemble dash in reverse order of removal after controller installation and wiring connections are complete.

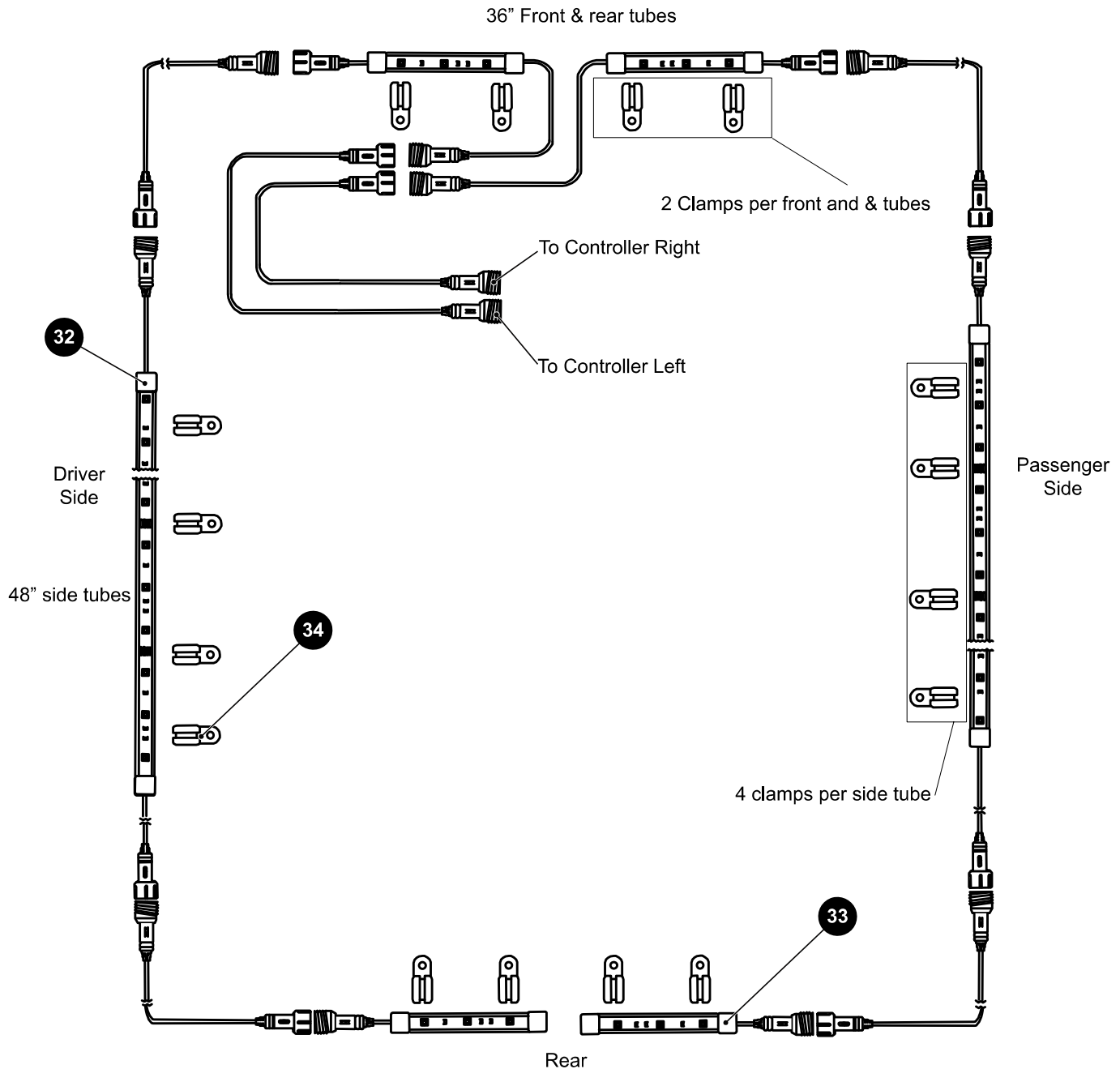

NOTICE: Mounting locations of LED tubes, wiring and controller unit will vary depending on vehicle type.

1. Review the vehicle and locate suitable places to mount the four LED tubes and routing paths for the cables. Avoid locations that are hot, move, pinch points, the gas tank and gas lines.
2. Install side tubes with four clamps (34) and front/rear tubes with two clamps as shown. Try to evenly space the clamps and do not position the clamp directly over an LED.
3. Starting at the controller, connect the left extension (driver side) and route to the front left tube, orienting tubes as shown.
4. Mount the tube with clamps (34) and self-tapping screws (35). Secure the cable with zip-ties (36) every 12 inches.
5. Continue to connect the tubes and extension, mounting the tubes as you go.
6. Repeat the process for the right circuit (passenger side).

7. Download app (see QR code). Test functionality with remote and app.

F. Reassembly

1. Reinstall dash panel, cowl, fascia, floor mat and hanging pedals in reverse order of removal.
2. Tighten hardware to the torque value shown below.

Item	Torque Specification
bolt (B)	13 - 15 ft. lbs (18 - 20 Nm)
screw (C, E)	3.5 - 3.9 ft. lbs (4.75 - 5.25 Nm)
T45 Torx (J)	14 - 15.5 ft. lbs (19 - 21 Nm)

G. Reconnect Battery Cables

1. Reconnect the negative (-) battery cable to the negative (-) battery post.
2. Reconnect the positive (+) battery cable to the positive (+) battery post.
3. Tighten hardware to the torque value shown below.

Item	Torque Specification
Battery Hardware	7 - 9 ft. lbs (10 - 12 Nm)

