

INSTALLATION INSTRUCTIONS

RXV Signature Headlight Kit

KIT PN 10015456

READ ALL INSTRUCTIONS BEFORE INSTALLING THIS KIT.

WARNING

Turn the key to the OFF position and remove it from the switch. Install wheel chocks in front and behind each wheel before installation procedure.

To prevent battery explosion that could result in severe personal injury or death, keep all smoking materials, open flames, or sparks away from the batteries.

Use insulated wrenches to decrease the risk of a dropped wrench from shorting out a battery, which could result in an explosion and severe personal injury or death.



When you service the vehicle, always wear eye protection. Be careful when working around batteries, or using solvents or compressed air.

TOOLS

- wheel chocks
- torque wrench (ft. lbs/Nm)
- socket wrench
- 14mm socket
- T30 Torx bit driver
- drill
- 1/4" drill bit

KIT CONTENTS

ITEM	QTY	PART NUMBER	DESCRIPTION
1	3	627035	PLUG, PANEL, CARLING SWITCH
2	1	10047123G41	HEADLIGHT ASSEMBLY, LED, LEVEL 4, LH
3	1	10047123G42	HEADLIGHT ASSEMBLY, LED, LEVEL 4, RH
--	1	10025358	TURN SIGNAL STALK KIT (INCLUDES ITEMS 9 - 14)
4	1	10024954	TURN STALK HOUSING HARNESS
5	1	10024955	STEERING COLUMN COVER
6	1	10020050	TURN SIGNAL COVER SWITCH
7	2	10023448	TURN SIGNAL STRAP
8	4	10025359	HEX HEAD BOLT, M5X12
9	2	16816G2	RATCHET RIVET
10	4	10033018	T30 PLASTITE SCREW, M6X2.14X20
--	1	10026529	RGB CONTROLLER W/REMOTE KIT (INCLUDES ITEMS 11 - 14)
11	1	10006260	RGB CONTROLLER
12	2	645340	CABLE TIE
13	1	10026480	RGB CONTROLLER REMOTE
14	1	10038194	PHOTOSENSITIVITY WARNING DECAL
--	1	10017178	HEADLIGHT ADAPTER HARNESS, RGB KIT
15	2	10015236	HEADLIGHT ADAPTER HARNESS, RGB
16	3	17618G1	NYLON CLAMP

VEHICLE PREPARATION

1. Compare the kit contents list to the parts packaged in the kit. Ensure all parts are included before beginning installation.
2. Park vehicle on a flat surface.
3. Turn the key to the OFF position and remove the key from the switch.
4. Chock wheels to keep vehicle from rolling.
5. Use an insulated wrench to disconnect the battery cables. Disconnect the negative (-) cable first, then disconnect the positive (+) cable.

A. Remove Dash Panel and Cowl

1. Remove windshield (if equipped):
 - a. Remove the four lock nuts (A) and four bolts (B) securing the lower portion of the windshield (C) to the vehicle.
 - b. Fold down the upper portion of the windshield.
 - c. Pull the rubber clips (D) away from the front strut.
 - d. Remove windshield from vehicle.

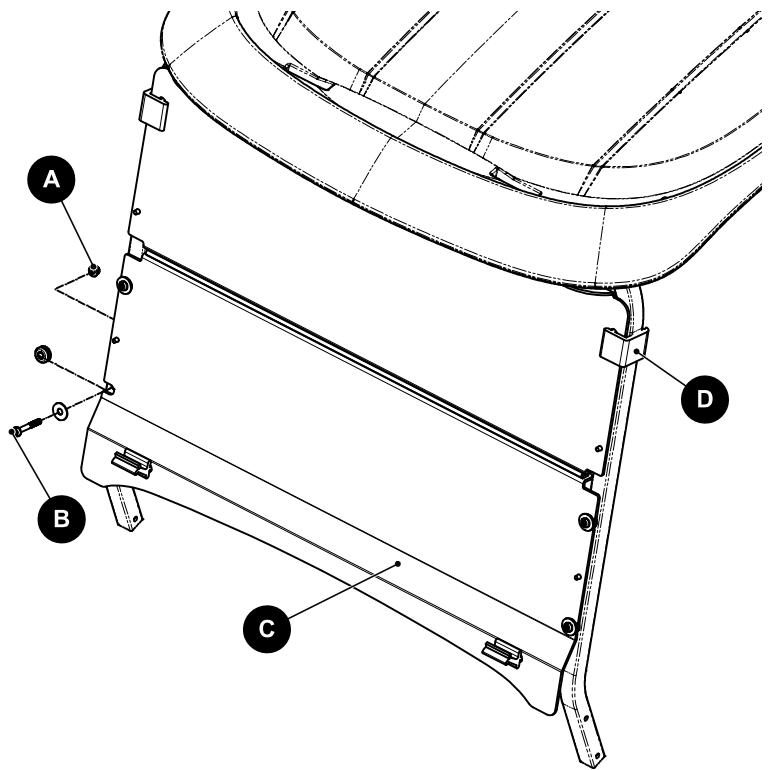

2. Remove the upper dash panel:
 - e. Slide the strut grommets (F) up the strut.
 - f. Remove strut covers (E) from dash.
 - g. Remove the two T30 plastite screws (G) securing the upper dash panel to the vehicle.
 - h. Remove upper dash panel (H).

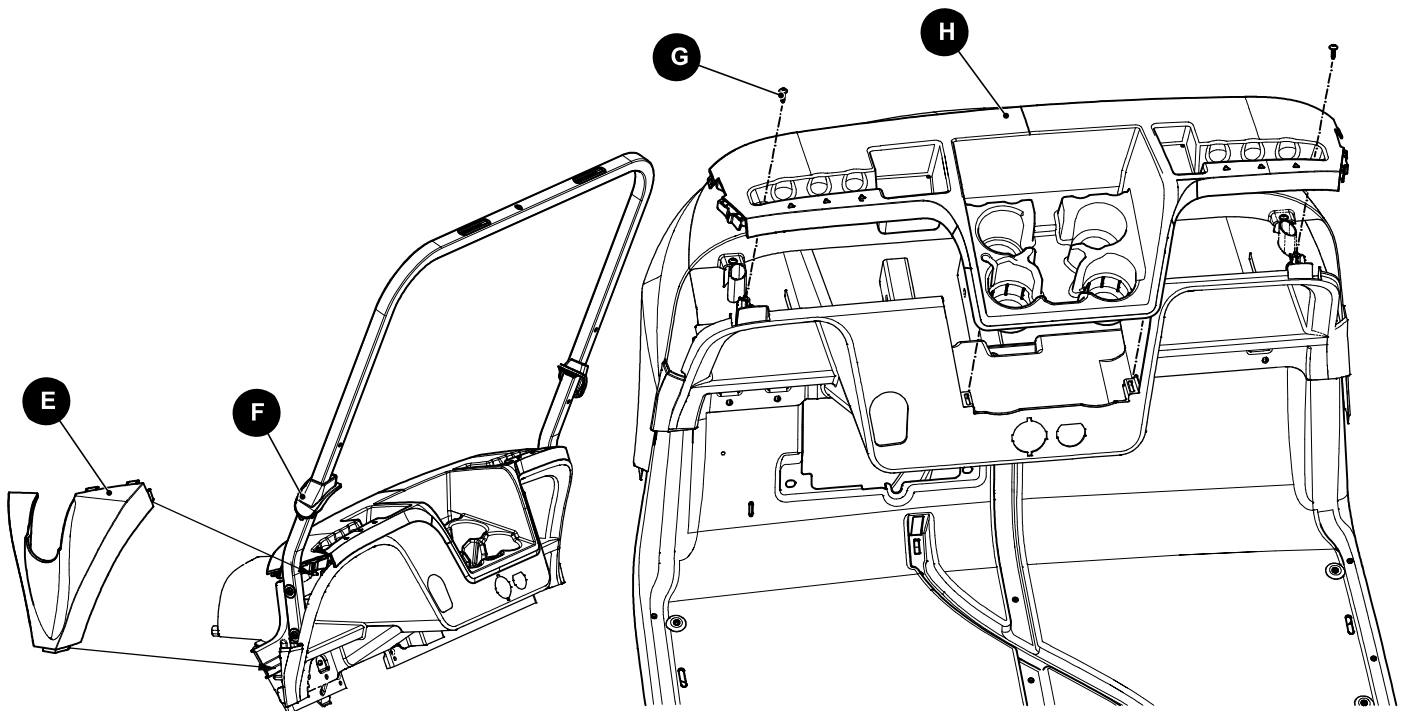

3. Remove the cowl by removing two T30 plastite screws (I) and pulling mounting tabs located at front bottom edge of cowl from the upper portion of the front fascia.

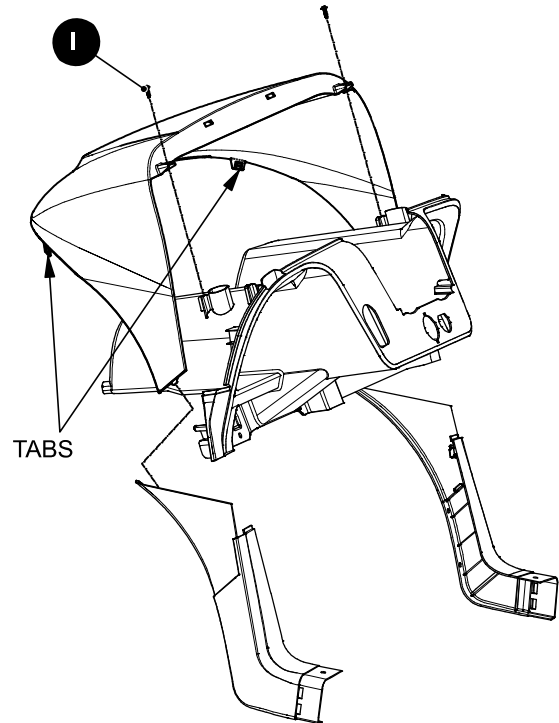

4. Remove fascia by removing two T45 Torx screws (J) and unhooking bottom edge from vehicle frame.

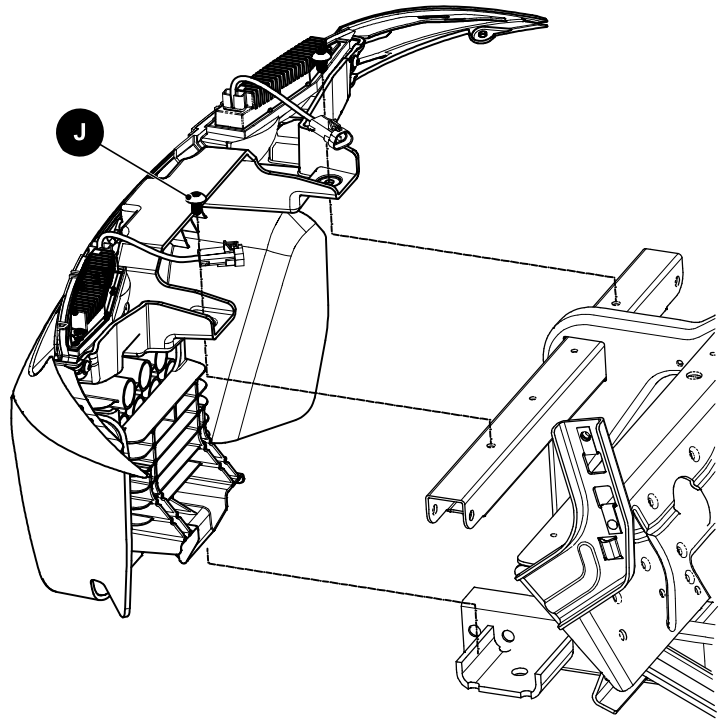

B. Headlight Installation

NOTICE: If vehicle is already equipped with headlights, pull grille out from mounting points, unplug harnesses and remove four T30 Torx screws to remove.

1. Install headlights (2, 3) as shown using four T30 plastite screws (10).

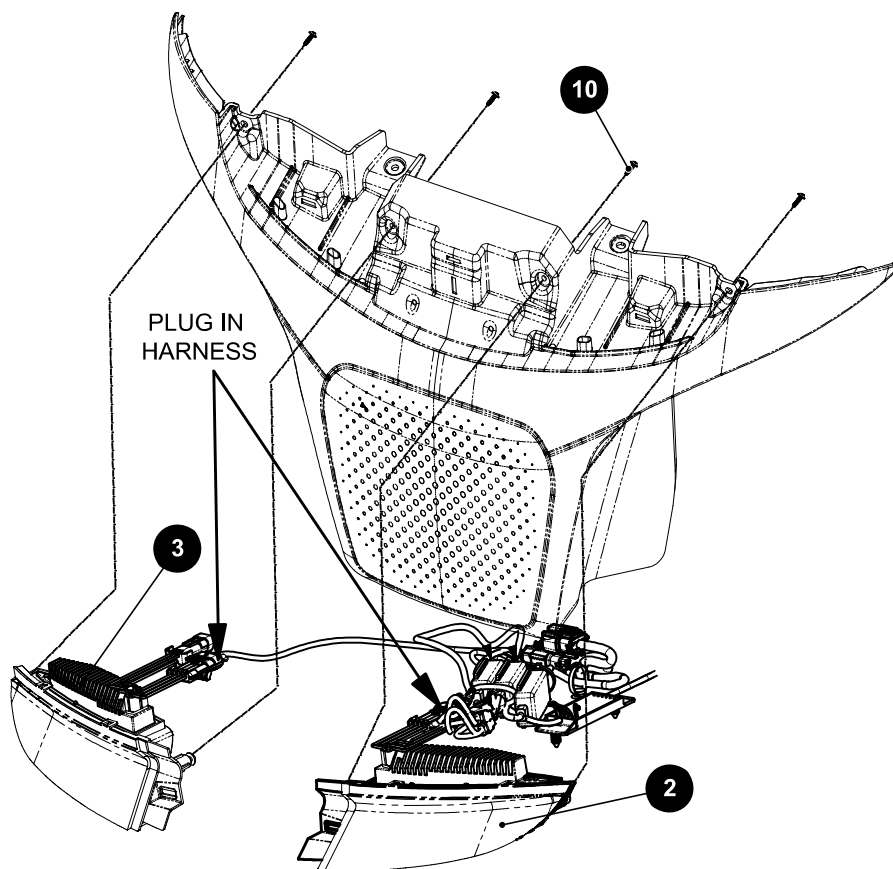

2. Tighten hardware to the torque value shown below.

Item	Torque Specification
bolt (10)	3 - 4 ft. lbs (4 - 5 Nm)

3. Plug headlights into harness as shown.
4. Reinstall grille between headlights by pressing firmly into place.
5. Reinstall the fascia in reverse order of removal.

C. Install In-Line Adapters

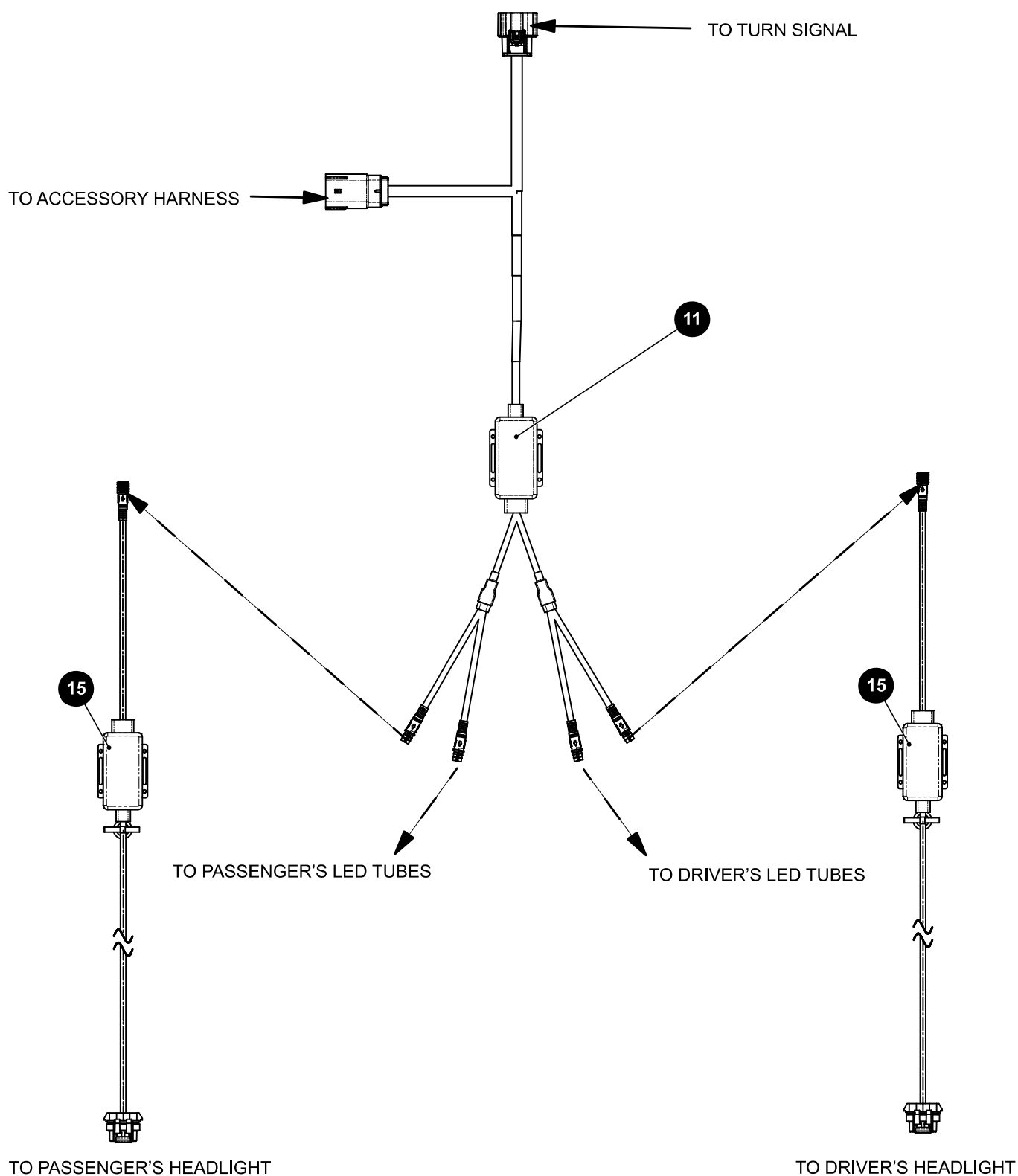

1. Plug 12 pin connector of RGB controller harness (11) into vehicle accessory harness.
2. Connect RGB headlight adapter harnesses (15) to one of the two connections at the end of the RGB controller harness (11) as shown.
3. RGB controller harness (11) is labeled LEFT and RIGHT. Connect LEFT connection branch to DRIVER'S headlight. Connect RIGHT connection branch to PASSENGER'S headlight.
4. Connect second RGB controller harness (11) connection to LED tube connections. Connect LEFT connection to DRIVER'S side of vehicle LED tube harness. Connect RIGHT connection to PASSENGER'S side LED tube harness.

D. Mount RGB Controllers

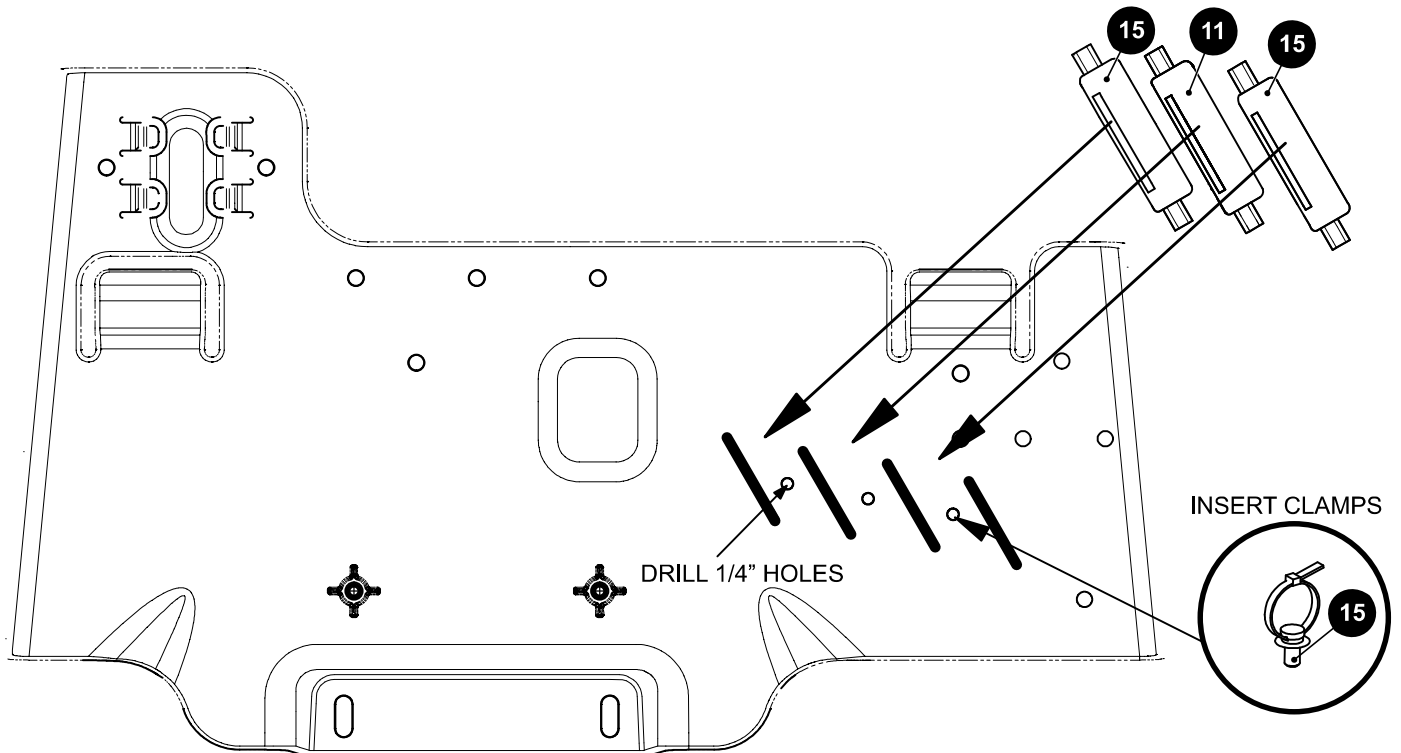

1. Mark the center of the three dividers located on the splash tray shown in image above and drill holes using a 1/4" drill bit.
2. Insert fir tree clamps (15) into holes.
3. Place controller modules (11,15) into dividers in the order shown.
4. Fix modules into place by securing the fir tree clamps around the modules.
5. Bundle wiring and secure with nylon clamps (16) as shown below.

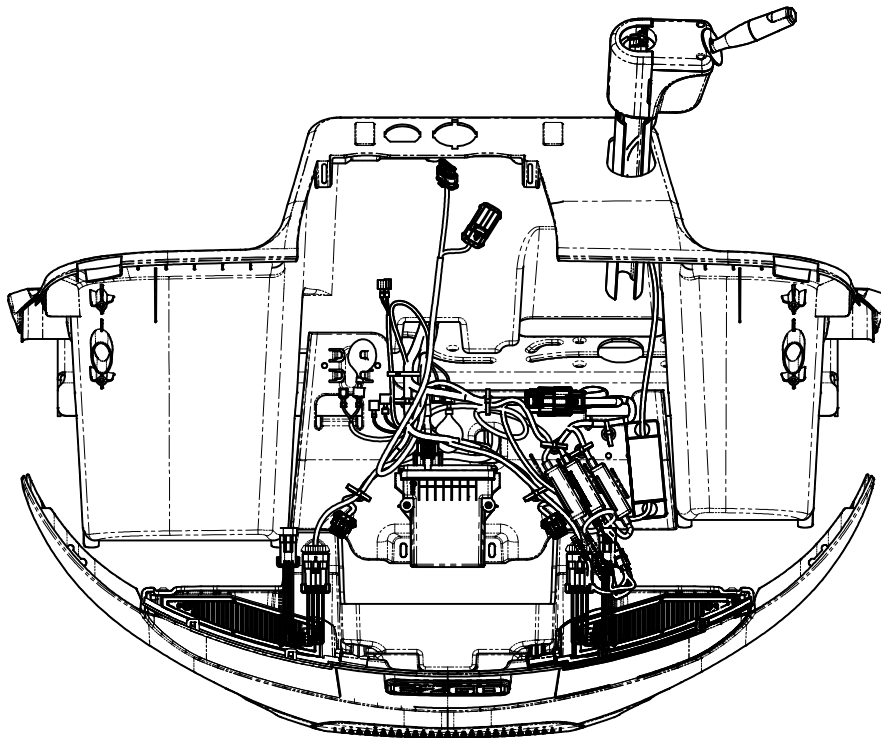

E. Install Turn Signal Kit

NOTICE: If vehicle is equipped with dash-mounted turn signal, remove the switch, harness and controller that is plugged into the vehicle accessory harness prior to installation of steering column mounted turn signal stalk kit. Fill any unused holes in dash with plugs (1).

1. Install turn signal per the instructions included with the kit.
2. Plug turn signal harness into RGB control harness (11) from step C.

F. Install Label

NOTICE: DO NOT USE PARTY MODE OR STROBE MODE WHILE OPERATING ON PUBLIC ROADS OR HIGHWAYS. THIS MODE SHOULD ONLY BE USED FOR ENTERTAINMENT OR SOCAIL SETTINGS.

1. Select a location to mount decal that is visible while operating the vehicle.
2. Clean mounting location with a shop towel and isopropyl alcohol.
3. Remove backing and apply decal (14) to clean mounting location, applying pressure with fingers to ensure adhesion.

G. Reassembly

1. Reinstall dash panel and cowl in reverse order of removal.
2. Tighten hardware to the torque value shown below.

Item	Torque Specification
bolt (B)	13 - 15 ft. lbs (18 - 20 Nm)
screw (C, E)	3.5 - 3.9 ft. lbs (4.75 - 5.25 Nm)

H. Reconnect Battery Cables

1. Reconnect the negative (-) battery cable to the negative (-) battery post.
2. Reconnect the positive (+) battery cable to the positive (+) battery post.
3. Tighten hardware to the torque value shown below.

Item	Torque Specification
Battery Hardware	7 - 9 ft. lbs (10 - 12 Nm)

